

# TRINSIC SIDE BOX ACE L

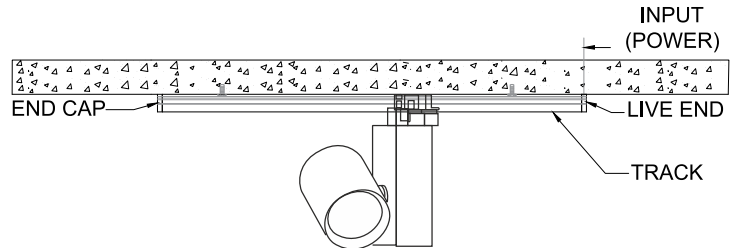
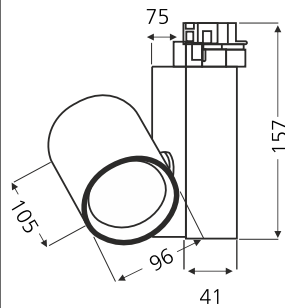

	<b>Class III</b> 220-240 V~50/60Hz	<b>Power</b> 35 Watts	<b>IP Rating</b> IP44
--	---------------------------------------	--------------------------	--------------------------

**CAUTION** - Must Be Installed By A Licensed Electrician Only.

- Please read the instructions for the installation of fixture provided below. Warranty will be void unless followed.
- The installation and operation of this fixture must be in accordance with the national safety regulations. L'azure is not liable when damage is caused due to improper installation.
- Please read the detailed product specification sheet available at [www.lazurelighting.com](http://www.lazurelighting.com) for any technical information regarding the fixture.
- Over-voltage protection units should be installed in order to prevent electronic and electrical components from failing due to voltage spikes.

**STEP 1**

RECESSED TRACK  
SURFACE TRACK  
SUSPENDED TRACK

TURN OFF THE SWITCH

TURN OFF THE ELECTRICITY AT THE MAIN ELECTRICAL PANEL

**STEP 2**

INSTALL THE TRACK AS REQUIRED

**STEP 3**

RECESSED TRACK  
INPUT (POWER)  
SURFACE TRACK  
SUSPENDED TRACK

CONNECT THE MAINS CABLE TO THE TRACK INPUT (LIVE END)

**STEP 4**

PUSH OFF  
ON  
TRACK  
INPUT (POWER)

PUSH THE END CAP  
PUSH TO ON

CONNECT THE FIXTURE TO THE TRACK AND LOCK THE FIXTURE

**STEP 5**

INPUT (POWER)  
END CAP  
TRACK  
TWIST  
PUSH THE LIVE END

FIX THE END CAPS OF THE TRACK

**STEP 6**

TURN ON THE SWITCH

INPUT (POWER)  
END CAP  
TRACK  
LIVE END

TILT, ROTATE AND AIM AS REQUIRED  
THE FIXTURE IS INSTALLED

**Disclaimer :** 1. Due to continuous product improvement the installation method is subject to change.  
2. Images and procedures are for representation and reference purpose only.